

**BKSSL**  
SOLID STATE LIGHTING

THE POWER OF



**MAMMOTH™**

PROJECT:

TYPE:

CATALOG  
NUMBER:

SOURCE:

NOTES:

## CATALOG NUMBER LOGIC

Example **MA** - **LED** - **x43** - **FL** - **BLP** - **12** - **11** - **B**

Series **MA** - Mammoth Series™

Source **LED** - 'X' Technology with Chip on Board Construction

LED Type  
**x43** - 31WLED/2.7K  
**x44** - 31WLED/3K  
**x45** - 31WLED/4K  
**x46** - 42WLED/2.7K  
**x47** - 42WLED/3K  
**x48** - 42WLED/4K  
**x49** - 52WLED/2.7K  
**x50** - 52WLED/3K  
**x51** - 52WLED/4K

Optics  
**NSP** - Narrow Spot (18")\*  
**NFL** - Narrow Flood (25")  
**FL** - Flood (40")  
**WFL** - Wide Flood (60")  
\*Only available for x43, x44 and x45.

Finish

### Standard Finish

Powder Coat Color	Satin	Wrinkle
Bronze	<b>BZP</b>	<b>BZW</b>
Black	<b>BLP</b>	<b>BLW</b>
White (Gloss)	<b>WHP</b>	<b>WHW</b>
Aluminum	<b>SAP</b>	—
Verde	—	<b>VER</b>

### Premium Finish

<b>ABP</b> Antique Brass Powder	<b>CMG</b> Cascade Mountain Granite	<b>RMG</b> Rocky Mountain Granite
<b>AMG</b> Aleutian Mountain Granite	<b>CRI</b> Cracked Ice	<b>SDS</b> Sonoran Desert Sandstone
<b>AQW</b> Antique White	<b>CRM</b> Cream	<b>SMG</b> Sierra Mountain Granite
<b>BCM</b> Black Chrome	<b>HUG</b> Hunter Green	<b>TXF</b> Textured Forest
<b>BGE</b> Beige	<b>MDS</b> Mojave Desert Sandstone	<b>WCP</b> Weathered Copper
<b>BPP</b> Brown Patina Powder	<b>NBP</b> Natural Brass Powder	<b>WIR</b> Weathered Iron
<b>CAP</b> Clear Anodized Powder	<b>OCP</b> Old Copper	Also available in RAL Finishes See submittal SUB-1439-00

Lens Type  
**12** - Soft Focus Lens

Shielding  
**11** - Honeycomb Baffle

Cap Style  
**B** - 90°  
**C** - Flush  
**E** - 90° less Weep Hole  
(Interior Use Only)

### Configure Driver Housing Separately Driver Housing Required

#### REMOTE DRIVER HOUSINGS:

**PM3DRM** - Universal Power Module 3 Dual Remote  
**DRM** - Dual Remote Wall Mount

## LM79 DATA

BK No.	Lumens (Source)(Tj=85°C)	CCT (Typ.)	CRI (Ra. Typ.)	Color Consistency	Input Watts (Typ.)
x43	3150	2700K	80	±60K	31
x44	3300	3000K	80	±60K	31
x45	3450	4000K	80	±60K	31
x46	4200	2700K	80	±60K	42
x47	4350	3000K	80	±60K	42
x48	4600	4000K	80	±60K	42
x49	5700	2700K	80	±60K	52
x50	5900	3000K	80	±60K	52
x51	6200	4000K	80	±60K	52

## L70 DATA

Minimum Rated Life (hrs.) 70% of initial lumens (L70)
50,000
50,000
50,000
50,000
50,000
50,000
50,000
50,000
50,000
50,000

## OPTICAL DATA

Beam Type	Angle	x45 CBCP	x48 CBCP	x51 CBCP
Narrow Spot	18°	20780	N/A	N/A
Narrow Flood	25°	5908	17560	23105
Flood	40°	4174	5539	7311
Wide Flood	60°	2931	3725	4966

**B-K LIGHTING**

40429 Brickyard Drive • Madera, CA 93636 • USA  
559.438.5800 • FAX 559.438.5900  
www.bklighting.com • info@bklighting.com

SUBMITTAL DATE  
02-12-15

DRAWING NUMBER  
SUB-2364-00

THIS DOCUMENT CONTAINS PROPRIETARY INFORMATION OF B-K LIGHTING, INC. AND ITS RECEIPT OR POSSESSION DOES NOT CONVEY ANY RIGHTS TO REPRODUCE, DISCLOSE ITS CONTENTS, OR TO MANUFACTURE, USE OR SELL ANYTHING IT MAY DESCRIBE. REPRODUCTION, DISCLOSURE OR USE WITHOUT SPECIFIC WRITTEN AUTHORIZATION OF B-K LIGHTING, INC. IS STRICTLY FORBIDDEN.

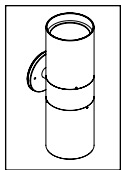

**BKSSL**  
SOLID STATE LIGHTING

THE POWER OF



**MAMMOTH™**

PROJECT:

TYPE:

## FRONT VIEW

### "B/E" CAP

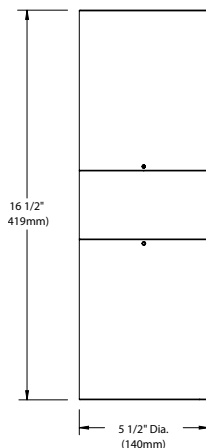

### "C" CAP

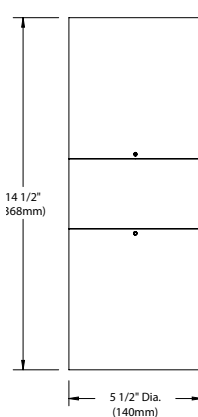

### CANOPY DETAIL

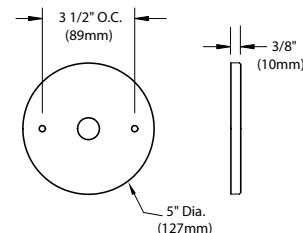

### MOUNTING RING

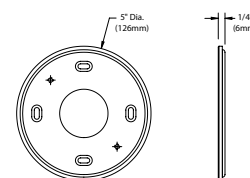

## SIDE VIEW

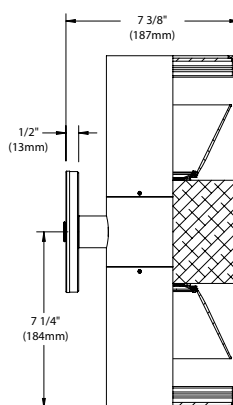
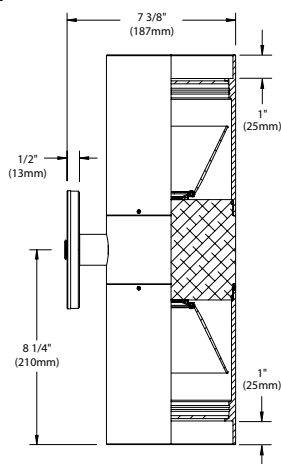

### Accessories (Configure separately)

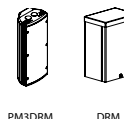

All dimensions indicated on this submittal are nominal.  
Contact Technical Sales if you require more stringent specifications.

## SPECIFICATIONS

### GreenSource Initiative™

Metal and packaging components are made from recycled materials. Manufactured using renewable solar energy, produced on site. Returnable to manufacturer at end of life to ensure cradle-to-cradle handling. Packaging contains no chlorofluorocarbons (CFC's). Use of this product may qualify for GreenSource efficacy and recycling rebate(s). Consult [www.bklighting.com/greensource](http://www.bklighting.com/greensource) for program requirements.

### Materials

Furnished in Copper-Free Aluminum (Type 6061-T6).

### Body

Fully machined from solid billet. Unibody design provides enclosed, water-proof wireway and integral heat sink for maximum component life. High temperature, silicone 'O' Ring provides water-tight seal.

### Cap

Fully machined. Accommodates [2] lens or louver media. Choose from 1" deep bezel with 90° cutoff ('B' or 'E') or flush lens ('C') cap styles. 'B' caps include weep-hole for water and debris drainage. 'E' caps exclude weep-hole and are for interior use only.

### Lens

Shock resistant, tempered, glass lens is factory adhered to fixture cap and provides hermetically sealed optical compartment.

### BKSSL®

Integrated solid state system with 'X' technology is scalable for field upgrade. Modular design with electrical quick disconnects permit field maintenance. Minimum 50,000 hour rated life at 70% of initial lumens (L70). BKSSL technology provides long life, significant energy reduction and exceptional thermal management.

### Color Management

Chip on board technology delivers natural white light. Exact color point conformity exceeds ANSI C78.377 standard. Module exceeds 80 CRI (RA>80, R9.16). Color point uniformity 2 SDCM color control for 2.7K-4K CCT.

### Remote Driver

For use with remote LED Driver. See remote driver submittal(s) to determine remote distance, dimming range, and wiring requirements prior to detailing field installation of any remote wiring.

### Installation

5" dia., machined canopy with machined aluminum mounting ring permits mounting to 4" octagonal junction box (by others).

### Optics

Interchangeable OPTIKIT™ modules permit field changes to optical distribution.

### Wiring

PVC coated, 18AWG, 150V, 60°C rated and certified to UL 1838 standard.

### Hardware

Tamper-resistant, stainless steel hardware. Canopy mounting screws are additionally black oxide treated for additional corrosion resistance.

### Finish

StarGuard®, our exclusive RoHs compliant, 15 stage chromate-free process cleans and conversion coats aluminum components prior to application of Class 'A' TGIC polyester powder coating.

### Warranty

5 year limited warranty.

### Certification and Listing

ITL tested to IESNA LM-79. Lighting Facts Registration per USDOE ([www.lightingfacts.com](http://www.lightingfacts.com)). ETL Listed to ANSI/UL Standard 1598 and Certified to CAN/CSA Standard C22.2 No. 250. RoHs compliant. Suitable for indoor or outdoor use. Suitable for use in wet locations. IP66 Rated. Made in USA.



**B-K LIGHTING**

40429 Brickyard Drive • Madera, CA 93636 • USA  
559.438.5800 • FAX 559.438.5900  
[www.bklighting.com](http://www.bklighting.com) • [info@bklighting.com](mailto:info@bklighting.com)

SUBMITTAL DATE  
02-12-15

DRAWING NUMBER  
SUB-2364-00

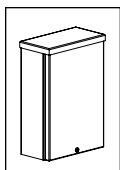

**BKSL**  
SOLID STATE LIGHTING

Constant Current Driver

THE POWER OF



# NEMA 3R Dual Remote Driver Housing

PROJECT:

TYPE:

FRONT VIEW

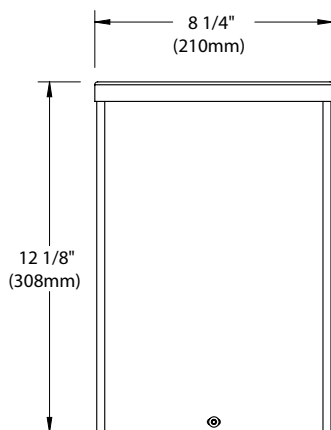

SIDE VIEW

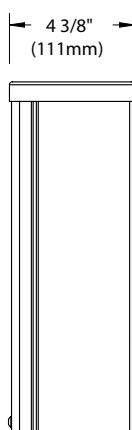

BACK VIEW

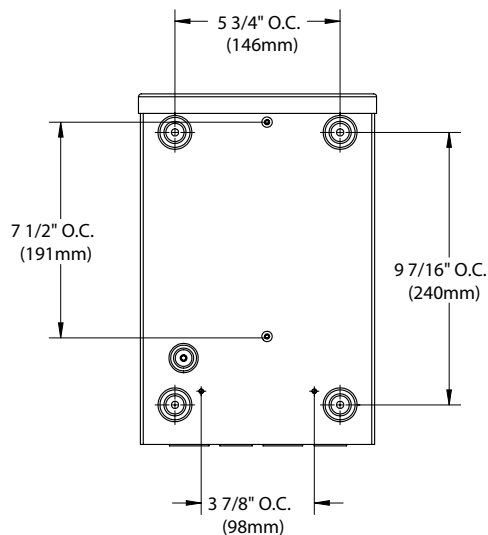

END VIEW

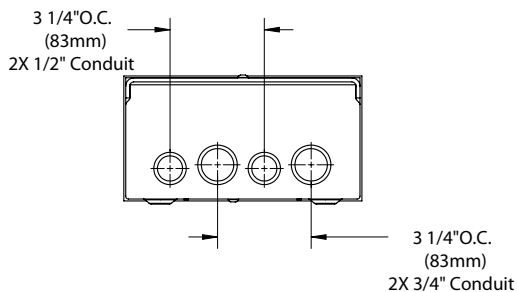

## SPECIFICATIONS

### GreenSource Initiative™

Metal and packaging components are made from recycled materials. Manufactured using renewable solar energy, produced on site. Returnable to manufacturer at end of life to ensure cradle-to-cradle handling. Packaging contains no chlorofluorocarbons (CFC's). Use of this product may qualify for GreenSource efficacy and recycling rebate(s). Consult [www.bklighting.com/greenSource](http://www.bklighting.com/greenSource) for program requirements.

### Installation

Nema 3R, surface mount design. For use with remote fixtures (specified separately).

### Housing

Steel construction with screw cover. Front access for ease of installation and inspection. [2] bottom entry, 3/4" conduit knockouts.

### Wiring / Connectors

Teflon® coated wire, 18 gauge, 600V, 250°C rated and certified to UL1659 standard. Pre-wired and labeled terminal strip.

### Driver (11-29W)

For use with [2] 700mA (D11) or 1.05A (D18, D29), Class A, constant current drivers. 120-277VAC (nominal) primary input voltage. 50/60Hz. >0.94 Power Factor, <15.0A in-rush current, 0.25A input current, ≤20%THD (nominal at 120VAC full load). Output over-voltage, over-current, and short circuit protection with auto recovery. EMC: FCC47CFR Part 15 Class B compliant. Dimming driver for use with standard incandescent dimmers. 10-100% range.

### Driver (31-52W)

[2] 1.05A (D31, D42) or 1.4A (D52), Class A, constant current drivers. 120-277VAC (nominal) primary input voltage. 50/60Hz. >0.90 Power Factor, <15.0A in-rush current, ≤20%THD (nominal at 120VAC full load). Output over-voltage, over-current, and short circuit protection with auto recovery. EMC: FCC47CFR Part 15 Class B compliant. Dimming driver for use with standard 0-10V dimmers and switch controls. 0.1-100% range (refer to driver electrical data).

### Finish

StarGuard®, our exclusive RoHs compliant, 15 stage chromate-free process cleans and conversion coats aluminum components prior to application of Class 'A' TGIC polyester powder coating.

### Warranty

5 year limited warranty.

### Listings

NEMA 3R Enclosure. ETL Listed to ANSI/UL Standard 50/50E and Certified to CAN/CSA Standard C22.2 No. 94.1/94.2. RoHs compliant. Made in USA.



RoHS

©Teflon is a registered trademark of DuPont Corporation.

**B-K LIGHTING**

40429 Brickyard Drive • Madera, CA 93636 • USA  
559.438.5800 • FAX 559.438.5900  
[www.bklighting.com](http://www.bklighting.com) • [info@bklighting.com](mailto:info@bklighting.com)

SUBMITTAL DATE  
12-16-14

DRAWING NUMBER  
SUB001125